

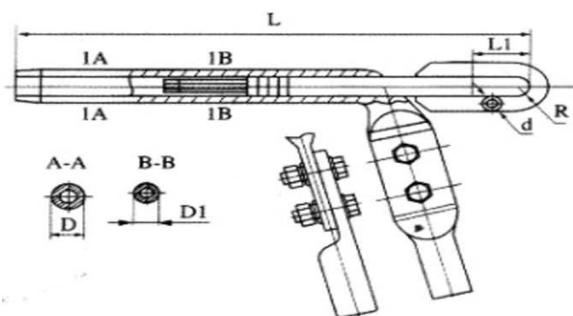

STRAIN CLAMP

Strain clamps are used to fix conductors and ground wires to insulators or link fittings to tower arms and substation structures.

1. NY Hydraulic Strain Clamp for Conductor (bolted type)



Catalog No.	Applicable Conductor Diameter (mm)	Main Dimensions (mm)						Slip Strength (kN)	Weight (kg)
		D	D1	d	L	L1	R		
NY-95/20	LGJ-95/20	30	14	14	410	55	9	35	1.80
NY-120/70	LGJ-120/70	36	20	18	445	65	12	94	2.70
NY-150/25	LGJ-150/25	32	14	16	440	55	10	51	2.10
NY-150/35	LGJ-150/35	32	16	18	465	55	10	62	2.25
NY-185/25	LGJ-185/25	32	14	16	450	55	10	56	2.30
NY-185/30	LGJ-185/30	32	16	18	475	55	10	61	2.40
NY-240/30	LGJ-240/30	36	16	18	490	55	10	70	2.60
NY-240/40	LGJ-240/40	36	16	18	500	55	10	80	2.70
NY-300/15	LGJ-300/15	40	14	16	470	55	10	65	2.90
NY-300/25	LGJ-300/25	40	16	18	495	55	11	70	3.00
NY-300/40	LGJ-300/40	40	16	18	540	55	11	90	3.25
NY-300/50	LGJ-300/50	40	18	18	560	65	12	100	3.40
NY-300/70	LGJ-300/70	42	22	22	600	70	13	120	3.70
NY-400/20	LGJ-400/20	45	14	18	540	50	11	85	3.60
NY-400/25	LGJ-400/25	45	14	18	555	55	11	90	3.70
NY-400/35	LGJ-400/35	45	16	18	570	65	12	100	4.00
NY-400/50	LGJ-400/50	45	20	20	595	70	13	120	4.50
NY-400/65	LGJ-400/65	48	22	22	625	70	13	130	5.00
NY-400/95	LGJ-400/95	48	26	24	665	80	15	160	6.00
NY-500/35	LGJ-500/35	52	16	20	595	70	13	110	5.22
NY-500/45	LGJ-500/45	52	18	20	615	70	13	120	5.38
NY-500/65	LGJ-500/65	52	22	22	655	70	14	150	6.00
NY-630/45	LGJ-630/45	60	18	22	640	70	16	140	7.70
NY-630/55	LGJ-630/55	60	20	22	680	75	16	155	8.10
NY-630/80	LGJ-630/80	60	24	24	725	80	17	180	8.70

The clamp body and jumper are made of Aluminum Alloy, and other parts are forged steel with Hot Dip Galvanization processing.



2. NY-G Compression Strain Clamp for Steel Wires (welding type)

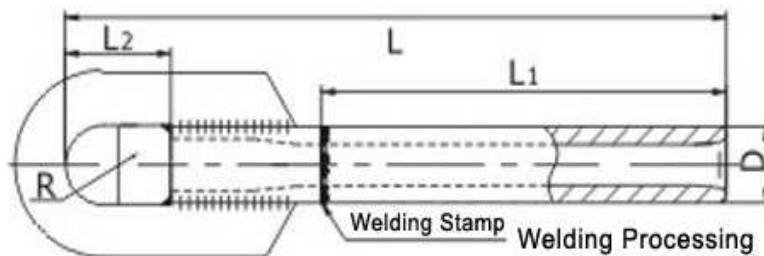

Catalog No.	Applicable Steel Wire Diameter (mm)	Main Dimensions (mm)							Slip Strength (kN)
		L	L1	L2	D	d	Φ	R	
NY-35G-W	7.80	215	115	55	16	8.40	16	8	45
NY-50G-W	9.00	220	130	55	18	9.70	16	9	60
NY-55G-W	9.60	230	140	55	20	10.2	16	10	70
NY-70G-W	11.0	255	155	60	22	11.7	18	11	88
NY-80G-W	11.5	275	175	55	24	12.2	18	12	100
NY-100G-W	13.0	295	185	70	26	13.5	20	13	123
NY-120G-W	14.0	315	195	75	28	14.7	22	14	143
NY-135G-W	15.0	340	215	75	30	15.7	22	15	164
NY-150G-W	16.0	380	230	90	32	16.7	24	16	187

Materials are Hot Dip Galvanized Steel.

3. NY-G Compression Strain Clamp for Steel Wires (forging types)

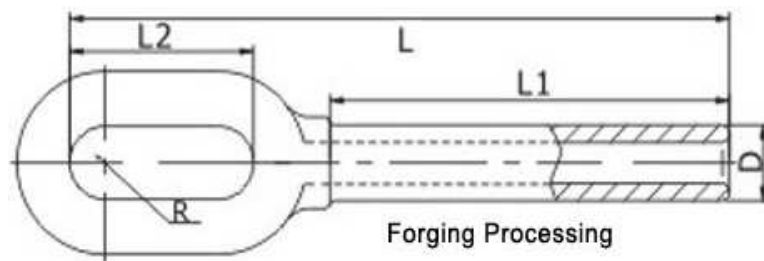

Catalog No.	Applicable Steel Wire Diameter (mm)	Main Dimensions (mm)							Slip Strength (kN)
		L	L1	L2	D	d	Φ	R	
NY-35G-F	7.80	200	115	55	16	8.40	16	8	45
NY-50G-F	9.00	215	130	55	18	9.70	16	9	60
NY-55G-F	9.60	225	140	55	20	10.2	16	10	70
NY-70G-F	11.0	245	155	60	22	11.7	18	11	88
NY-80G-F	11.5	260	175	55	24	12.2	18	12	100
NY-100G-F	13.0	290	185	70	26	13.5	20	13	123
NY-120G-F	14.0	310	195	75	28	14.7	22	14	143
NY-135G-F	15.0	335	215	75	30	15.7	22	15	164
NY-150G-F	16.0	365	230	90	32	16.7	24	16	187

Materials are Hot Dip Galvanized Steel.



4. NZG Strain Clamp (hydraulic compression type)

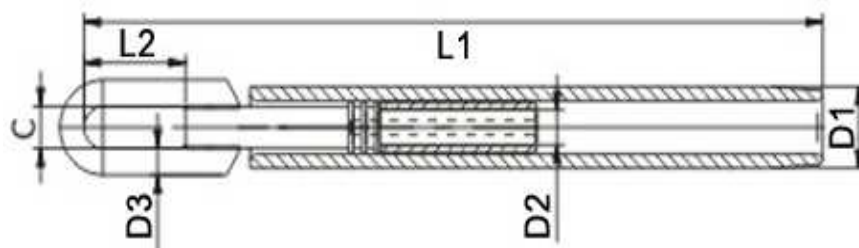

Catalog No.	Applicable Conductor Diameter (mm)	Main Dimensions (mm)						Slip Strength (kN)	Weight (kg)
		D1	D2	D3	L1	L2	C		
NZG-600K	LGKK-600	76	-	20	450	70	30	107	6.50
NZG-900K	LGKK-900	70	-	24	470	85	30	137	5.50
NZG-1400	LGJQT-1400	76	30	24	540	70	40	294	6.80
NZG-1440N	NAHLGJQ-1440	76	-	20	450	70	30	313	11.0

The body and jumper are Aluminum Materials; steel anchor is Hot Dip Galvanized Steel.

5. NY-N Strain Clamp for HRAAS Conductor (hydraulic compression)

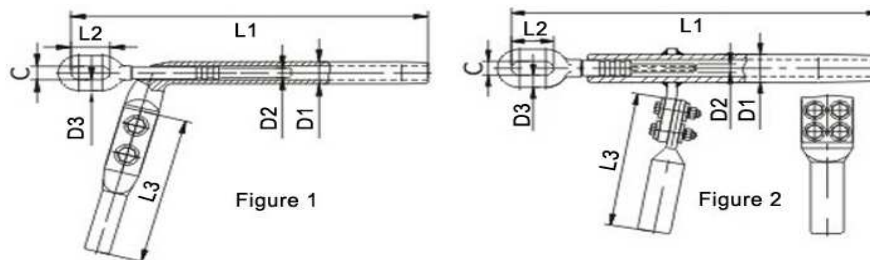

Catalog No.	Applicable Conductor NRLH-58(60)-GJ-	Fig.	Main Dimensions (mm)							Slip Strength (kN)
			D1	D2	D3	C	L2	L1	L3	
NY-185/25N	185/25	1	36	14	16	20	55	515	245	54
NY-185/30N	185/30	1	36	16	16	20	55	505	245	59
NY-240/30N	240/30	1	45	18	18	22	55	575	295	69
NY-240/40N	240/40	1	45	18	18	22	55	565	295	77
NY-300/25N	300/25	1	50	14	18	22	55	590	325	76
NY-300/40N	300/40	1	50	16	20	24	63	605	325	86
NY-300/50N	300/50	1	50	18	20	24	63	630	325	96
NY-400/35N	400/35	2	55	16	20	24	67	650	340	94
NY-400/50N	400/50	2	55	20	22	26	67	670	340	112
NY-500/35N	500/35	2	65	18	22	26	67	660	360	109
NY-500/45N	500/45	2	65	20	22	26	75	670	360	117
NY-500/65N	500/65	2	65	22	22	26	75	700	360	140
NY-630/45N	630/45	2	70	18	22	26	75	710	380	133
NY-630/80N	630/80	2	70	24	24	30	83	770	380	178
NY-800/55N	800/55	2	72	20	24	36	83	800	410	175

The clamp body, jumper are Aluminum Materials, other parts are hot dip galvanized steel.



6. NY-BG Strain Clamp for ACSR/AS Conductor (hydraulic compression)

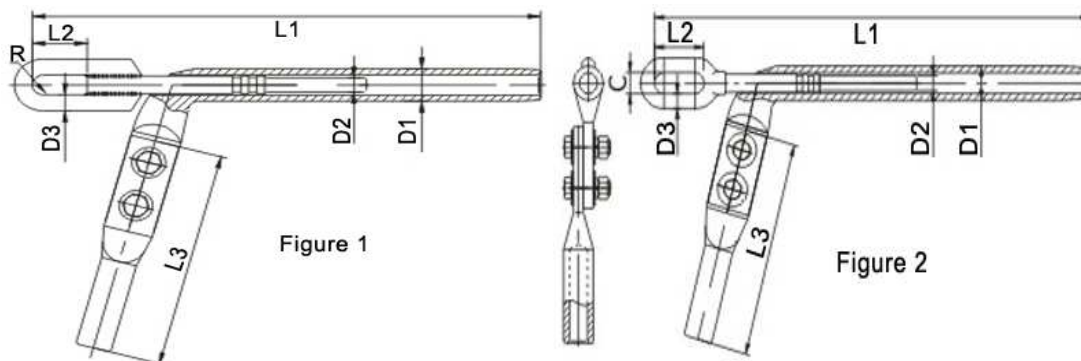

Catalog No.	Applicable Conductor Diameter (mm)	Main Dimensions (mm)							Slip strength (kN)	Weight (kg)
		D1	D2	D3	L1	L2	L3	R		
NY-70/40BG	ACSR/AS-70/40	34	16	16	480	50	180	9	57.8	0.4
NY-80/47BG	ACSR/AS-80/47	36	18	16	485	70	230	10	64.6	2.6
NY-95/55BG	ACSR/AS-95/55	36	22	18	486	65	200	11	74.0	2.9
NY-185/30BG	ACSR/AS-185/30	36	16	16	550	55	220	9	62.9	2.9
NY-240/40BG	ACSR/AS-240/40	38	18	18	595	65	240	12	81.6	3.3
NY-300/25BG	ACSR/AS-300/25	42	16	18	560	55	255	11	74.4	3.6
NY-300/40BG	ACSR/AS-300/40	42	18	18	615	70	270	13	90.0	3.8
NY-300/50BG	ACSR/AS-300/50	42	18	18	620	70	265	13	101.0	4.1
NY-300/70BG	ACSR/AS-300/70	42	22	20	640	70	260	13	117.8	4.4
NY-400/35BG	ACSR/AS-400/35	48	18	20	635	65	280	13	99.0	5.2
NY-400/50BG	ACSR/AS-400/50	48	20	20	645	65	280	13	117.0	5.2

Specifications below are according to Figure 2

Catalog No.	Applicable Conductor Diameter (mm)	Main Dimensions (mm)							Slip strength (kN)	Weight (kg)
		D1	D2	D3	L1	L2	L3	C		
NY-35BG	JLB 20A-35	32	18	20	230	55	200	16	38	1.92
NY-50BG	JLB 20A-50	32	18	20	250	55	200	16	57	1.96
NY-65BG	JLB 20A-65	36	22	22	285	6	210	18	73	2.71
NY-70BG	JLB 20A-70	36	22	22	285	65	210	18	78	2.76
NY-80BG	JLB 20A-80	36	24	22	325	65	210	18	85	3.15
NY-95BG	JLB 20A-95	40	26	22	340	65	250	18	96	3.75
NY-100BG.1	JLB 20A-100	40	28	26	340	78	250	20	116	4.34
NY-100BG.2	JLB30A-100	36	24	22	325	65	210	18	76	3.25
NY-120BG.1	JLB20A-120	42	30	26	340	78	250	22	139	5.00
NY-120BG.2	JLB30A-120	40	26	22	340	65	250	18	92	3.75
NY-150BG.1	JLB20A-150	45	32	30	390	85	260	24	170	6.62
NY-150BG.2	JLB30A-150	40	28	26	340	78	250	20	112	4.34
NY-185BG.1	JLB20A-185	48	34	30	435	85	260	24	199	7.92
NY-185BG.2	JLB30A-185	42	30	26	340	78	250	22	138	5.10

The clamp body, jumper are Aluminum Materials, other parts are hot dip galvanized steel.



7. NLL Aluminum Alloy Strain Clamp (bolted type)

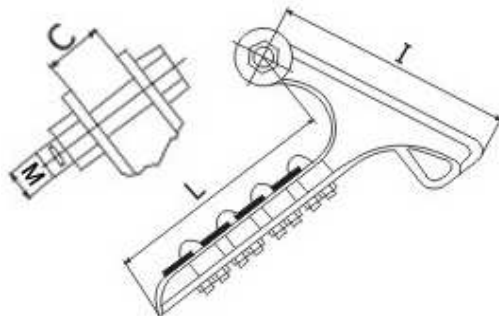

Catalog No.	Applicable Conductor Diameter (mm)	Dimensions (mm)		U Bolt		Failure Load (kN)	Weight (kg)
		C	M	PCS	Dia.(mm)		
NLL-1	5.00~11.4	18	16	2	M12	40	0.5
NLL-2	10.0~16.0	18	16	2	M12	40	1.8
NLL-3	14.0~18.0	28	18	3	M14	70	1.9
NLL-4	18.0~23.0	34	18	3	M14	90	4.1
NLL-5	23.0~30.0	36	18	5	M16	120	7.0
NLL-1A	4.50~13.3	16	16	2	M12	35	1.0
NLL-5A	8.00~30.0	32	18	3	M14	80	3.5
NLL-6A	30.0~38.0	39	18	3	M14	80	4.2

The clamp body and keeper are made of Aluminum Alloy, and the cotter-pins are Stainless Steel. Other parts are Hot Dip Galvanized Steel.

Custom sizes and drawings with special requirements are available upon request.

8. NLD Malleable Iron Strain Clamp (bolted type)

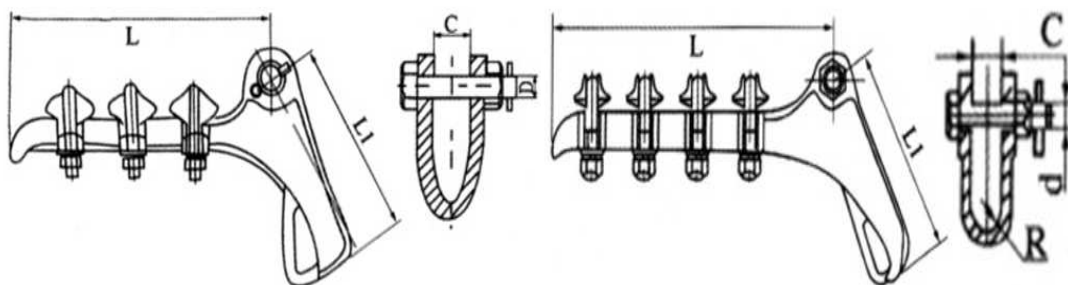

Catalog No.	Applicable Conductor Diameter (mm)	Dimensions (mm)		U Bolt		Failure Load (kN)	Weight (kg)
		C	D	PCS	Dia.(mm)		
NLD-1	5.00~10.0	18	16	2	M12	20	1.3
NLD-2	10.1~14.0	18	16	3	M12	40	2.1
NLD-3	14.1~18.0	22	18	4	M16	70	4.6
NLD-4	18.1~23.0	25	18	5	M16	90	7.1
NLD-4B	18.1~23.0	27	18	5	M16	90	7.1

The clamp body and keeper are made of Malleable Iron, and the cotter-pins are Stainless Steel. Other parts are Hot Dip Galvanized Steel.



9. NLZ Deadend Strain Clamp (bolted type)

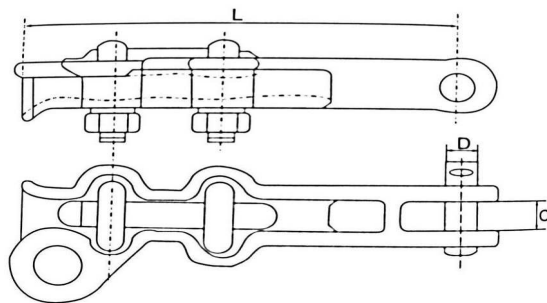

Catalog No.	Applicable Conductor Diameter (mm)	Dimensions (mm)			U Bolt (PCS)	Failure Load (kN)	Weight (kg)
		L	C	D			
NLZ-1L	3.80~9.4	114	18	16	2	20	0.60
NLZ-2L	5.8~10.4	195	19	16	2	35	0.85
NLZ-3L	7.60~15.2	195	19	16	2	45	1.05
NLZ-4L	11.7~22.4	240	24	16	2	45	1.35
NLZ-1T	3.80~9.4	114	18	16	2	30	1.20
NLZ-2T	5.8~10.4	195	19	16	2	45	1.70
NLZ-3T	7.60~15.2	195	19	16	2	55	2.10
NLZ-4T	11.7~22.4	240	24	16	2	55	2.70

The clamp body and keeper are made of Aluminum Alloy for NLZ-L series, Malleable Iron for NLZ-T series; cotter-pin is stainless steel and other parts are hot dip galvanized steel.

10. WNY Strain Clamp

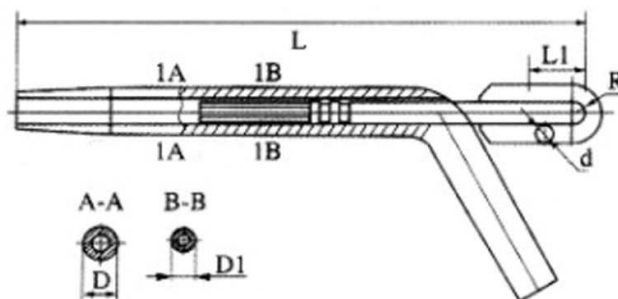

Catalog No.	Applicable Conductor Diameter (mm)	Main Dimensions (mm)						Slip Strength (kN)	Weight (kg)
		D	D1	d	L	L1	R		
WNY-70/40	LGJ-70/40	32	18	16	390	55	10	55	2.2
WNY-150/25	LGJ-150/25	30	14	16	400	55	8.5	52	2.1
WNY-240/40	LGJ-240/40	36	16	18	515	55	11	79	3.6
WNY-300/25	LGJ-300/25	40	14	18	570	55	11	79	3.4
WNY-300/40	LGJ-300/40	40	16	18	575	55	11	88	3.4
WNY-400/35	LGJ-400/35	45	16	20	620	55	12	89	3.8
WNY-400/50	LGJ-400/50	45	20	20	620	65	12	117	3.9

The clamp body and keeper are made of Aluminum Alloy, and the cotter-pins are Stainless Steel. Other parts are Hot Dip Galvanized Steel.



11. NY-H Aluminum Alloy Strain Clamp

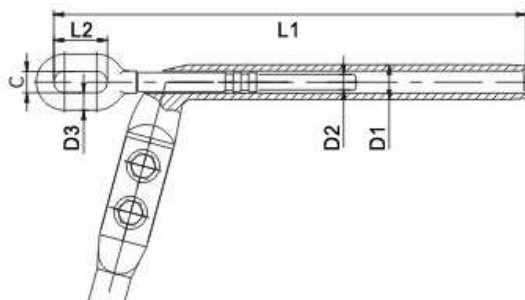

Catalog No.	Applicable Conductor Diameter (mm)	Main Dimensions (mm)						Slip Strength (kN)	Weight (kg)
		D1	D2	D3	L1	L2	C		
NY-120H	LHAJ-120	30	16	12	445	50	18	32.0	1.6
NY-185H	LHAJ-185	40	19	16	480	55	18	53.3	2.8
NY-300H	LHAJ-300	48	24	18	600	70	22	79.5	4.5

The clamp body and keeper are made of Aluminum Materials; other parts are Hot Dip Galvanized Steel.

12. NY-H Aluminum Alloy Strain Clamp

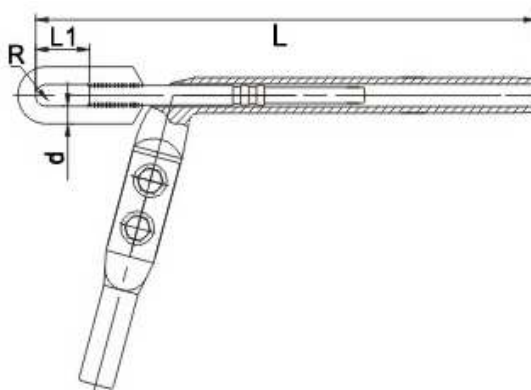

Catalog No.	Applicable Conductor Diameter (mm)	Main Dimensions (mm)				Slip Strength (kN)	Weight (kg)
		d	L	L1	R		
NY-70/40HG	LHBGJ-70/40	16	440	55	11	63.4	3.0
NY-120/70HG	LHBGJF-120/70	16	555	55	13	108.8	3.7
NY-240/30HG	LHBGJ-240/30	22	650	78	12	101.0	5.0
NY-300/50HG	LHBGJ-300/50	22	670	75	13	136.4	6.4
NY-300/70HG	LHBGJ-300/70	24	680	80	14	168.0	6.7

The clamp body, keeper are Aluminum Materials; other parts are hot dip galvanized steel.

If you fail to find model and types for your needs of strain clamps, please kindly send us e-mail for further information.